

Knife Gate Valves

Sizes 2" to 24", Class 150 and PN 10

L&T Valves offers Knife Gate Valves with metallic and resilient seats for bidirectional and unidirectional applications. The versatile range is available in wafer, lugged and flanged configurations.

The Knife Gate Valve provides reliable shut-off for both dry and wet line fluids. The bonnet-less valve is equipped with a heavy-duty gate to cut through sediments – and is ideally suited for abrasive slurries, pulp stock, semi-solids, dry ash, chips, etc. The valves find application in paper and pulp, minerals and metals, steel plants, thermal power plants and chemical/ petrochemical industries.



Compliance Standards

- Valve Design: MSS SP 81
- Wall Thickness: ANSI B16.34
- Face-to-Face: MSS SP 81
- Flange Dimensions: ANSI B16.5
- Testing Standard: MSS SP 151

Salient Features

- Sharp heavy-duty knife edge at the bottom of gate cuts through solid sediments and ensures reliable shut-off
- Gate offered with surface coatings based on customer demand - Hardfacing, Nitriding, Chrome-plating
- Replaceable seats - Easy maintenance at site. Longer service life
- Low operating torque - Facilitates use of a smaller-size actuators. Lower Initial Investment.

Accessories

- Deflection Cone
- V-Orifice
- Stem Extension
- Stem Protection
- Retainer Ring
- Protection Guard

Range

Type	Pressure Rating*	Size**	Seats	End connections
Uni-Directional	PN10	2"-24"	Metal, Soft	Lugged/ Wafer/ Flanged
	#150			
Bi-Directional	PN10	2"-24"	Soft	Lugged
	#150			

* Also offered: Valves in 75 psi to 150 psi

** Higher sizes on demand

Actuators

- Pneumatic: Double/ Single Acting
- Electro-Pneumatic
- Hydraulic
- Electrical

Automation Accessories

Solenoid Valve, Limit Switch, Proximity Switch, Junction Box, Positioner, Accumulator for Emergency Shutoff

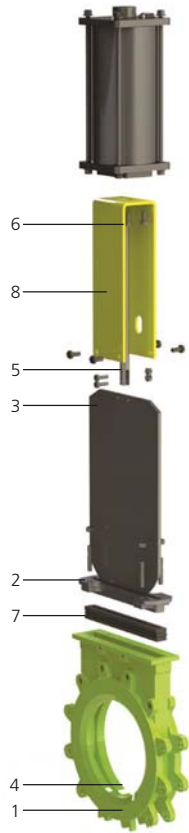

Materials of Construction

No.	Part	Materials								
		Ductile Iron	Cast Iron	Carbon Steel	Stainless Steels					
1	Body*	A 536 Gr. 60-40-18	IS 210 FG 200	A 216 Gr. WCB	A 351 Gr. CF8	A 351 Gr. CF8M	A 351 Gr. CF3M	A 351 Gr. CG8M	A 351 Gr. CG3M	A 351 Gr. CK3MCuN
2	Gland	A 536 Gr. 60-40-18	IS 210 FG 200	A 216 Gr. WCB	A 351 Gr. CF8	A 351 Gr. CF8M	A 351 Gr. CF3M	A 351 Gr. CG8M	A 351 Gr. CG3M	A 351 Gr. CK3MCuN
3	Gate	A240 SS 304				A240 SS 316	A240 SS 316L	A240 SS 317	A240 SS 317L	S31254 SMO 254
4	Seat	Integral Body Seat/ Resistant Seat with Metal Back-up Ring								
5	Stem	SS 410			A182 Gr. F316			A182 Gr. F44		
6	Stem Nut	Brass								
7	Gland Packing	PTFE-impregnated Synthetic Fiber (Optional: Graphite/ Ceramic) O Wire - EPDM (Optional: Viton™)								
8	Support Plate	A36/ Carbon Steel/ SS 304								

*Other materials available on demand

Industries

- **Paper & Pulp** Pulp Preparation, Pulp Transfer, Stock Tower Isolation
- **Minerals & Metals** Pneumatic Conveying, Iron Ore Slurry, Beneficiation Plant, Blast Furnace
- **Thermal Power** Ash Handling, Coal Handling
- **Sugar, Chemical & General Industries** Dry Solids Bagging, Hopper Dump, Pump Isolation, Silos
- **Cement** Slurry Transfer, Dry Lime, Pneumatic Conveying
- **Waste Water** Digester Isolation, Sludge Discharge, Sewage

Seat Options

Materials	Max. Temperature (°C)	Applications
Metal Seat	>250	High Temperature
EPDM	150	Acids & Oils
Nitrile	100	Petroleum Products
Viton®	200	Chemicals
PTFE	232	Corrosive Media
PTFE (25% Glass/ Carbon filled)	260	Highly Erosive Media



Oriental Trading Co.

3575, Netaji Subhash Marg
(Above Easyday Store)
Daryahganj, New Delhi-110002
Tele : 011-23278849, 23268849, 23269588, 23279588, 43573494
Email : sales@orientalgroup.co.in | orientaltrading@rediffmail.com

L&T Valves Limited

Mount - Poonamallee Road, Manapakkam, Chennai 600 089, INDIA
Tel. : +91 44 2252 9855 Email: ContactUs@Lntvalves.com www.Lntvalves.com CIN Number: U74999MH1961PLC012188

Registered Office: L&T House, N. M. Marg, Ballard Estate, Mumbai - 400 001, INDIA

Publication Number: LTVF001/1018/R2

As we continuously endeavour to improve our products, the data given herein is subject to change.
Please refer www.Lntvalves.com for the latest publication.

