



LASER EGG 2+

The smart air quality monitor for PM2.5 and TVOC



DESIGNED TO HELP YOU ENSURE YOUR HOME IS AS CLEAN AND AS SAFE AS YOU WANT IT TO BE.

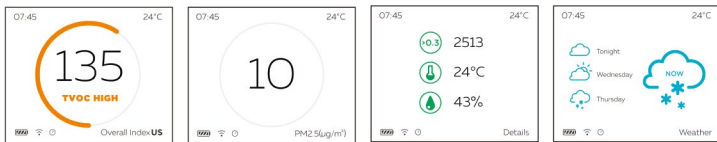

Combined air quality index for TVOC and PM2.5

PM2.5 concentration, used to calculate the AQI

Particle count, temperature, and humidity

Local weather forecast

KEY FEATURES:

- Measures TVOC in parts per million (PPM) and PM2.5
- TVOC includes gasses such as formaldehyde, benzene, chlorofluorocarbons
- Has a combined air quality index that takes into account both PM2.5 and TVOC so that you always know which one is higher and how to ensure your home has the best air quality.

1. Real-time measurements of PM2.5 levels; measurements are being taken every 0.1 seconds and can be displayed on the LCD screen in AQI (including US EPA Standards and Chinese Standards and more coming soon.)
2. Features Apple HomeKit technology so that you can control your air purifiers and other HomeKit products with it using HomeKit enabled smart plugs through the Home app on your iPhone or iPad.
3. Easy-to-use user interface and experience for all ages. Display all the home air quality data you need such as temperature, humidity and even weather forecasts.

OUR CLIENTS INCLUDE:



ONE DEVICE TO CONTROL YOUR HOME

Once connected, the Laser Egg 2+ can seamlessly control other smart home devices to ensure that air quality is maintained at a good level. Customizations can also be done using the accompanying app to manage settings for alarms, language, AQI standards and more.





| | | | |
|---|--------------------------------------|---|--|
| Material | : ABS plastic | TVOC measurement principle | : MEMS metal oxide semiconductor sensor technology |
| Colour | : White + silver ring | TVOC measurement range | : 125 – 600 ppb (relative). Readings above 600ppb also displayed |
| Connection | : Wi-Fi (2.4Ghz) | TVOC warm-up period | : 5 minutes after start up |
| Other connectivity | : Apple HomeKit technology | TVOC features | : automatic baseline correction |
| Screen | : 2.6" full colour LCD | Temperature measurement range: | : -20 – 125°C |
| Battery | : 2300mAh Lithium (~8 hours) | Temperature accuracy | : ±0.3°C |
| Input voltage | : DC-5V | Temperature resolution | : 1°C |
| Input current | : 1A | Temperature response time | : 2s |
| Dimensions | : 106*88mm | PM2.5 measurement principle | : Laser-based light scattering (mie) |
| Weight | : 285g | Measurable particle size | : 0.3µm – 10µm |
| PM2.5 measurement principle | : Laser-based light scattering (mie) | PM2.5 measurement range (AQI) | : 1-500 |
| Measurable particle size | : 0.3µm – 10µm | PM2.5 measurement range (PM2.5 concentration) | : 1-999µg/m³ |
| PM2.5 measurement range (AQI) | : 1-500 | PM2.5 resolution | : 1µg/m³ |
| PM2.5 measurement range (PM2.5 concentration) | : 1-999µg/m³ | PM2.5 accuracy | : ±10% |
| PM2.5 resolution | : 1µg/m³ | PM2.5 response time | : 100ms |
| PM2.5 accuracy | : ±10% | Relative humidity measurement range | : 0-100% |
| PM2.5 response time | : 100ms | Relative humidity accuracy | : ±3% |
| | | Relative humidity resolution | : ±1% |
| | | Relative humidity response time | : 8s |
| | | Supported operating systems | : iOS 9.0 and up, Android 4.2 and up. |
| | | Model Number | : LE-210 |

LASER EGG 2+ CAN BE USED IN THE FOLLOWING SCENARIOS:



When choosing renovation materials

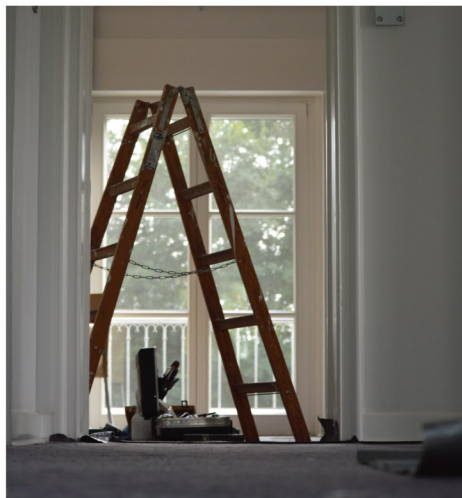

After renovation during the period when you let the smell dissipate



After you move in, you can ensure your home off-gassing is within safe limits

ABOUT US

Find out more about our products and services by contacting us:

 : www.kaiterra.com

 : info@kaiterra.com



Contact us:

+86 400-863-0600